

**MODEL DOD651PHXXLS**

**FEATURES**

Stainless steel wrapped exterior with pro handle and hidden controls

TouchProof™ stainless steel

Condensation drying system

15 place-setting capacity

Quiet operation—48 dB(A)

7Spray™ wash system; separate spray nozzles clean pots & pans and continuously spray the cutlery basket

9 wash programs

Delayed start—up to 24 hours

Heavy-duty stainless steel construction with nylon-coated steel racks

Knife rack

UL outdoor approved

**INTERIOR FEATURES**

- Premium upper rack
- Premium lower rack

**PROGRAMS**

- Time Program
- Sanitation Wash
- Normal Wash
- Plastic Wash
- Self Cleaning
- Hygiene Wash
- Crystal Glass
- Eco Wash
- Rinse and Hold

**PRODUCT SPECIFICATIONS**

Model	DOD651PHXXLS
Width	24 <sup>5</sup> / <sub>8</sub> "
Height	35" – 35 <sup>3</sup> / <sub>4</sub> "
Depth	25"
Door Clearance	24 <sup>5</sup> / <sub>8</sub> "
Weight	174 lb
Max Loading Height Upper Rack	9"
Max Loading Height Lower Rack	15 <sup>3</sup> / <sub>8</sub> "
Electrical Supply	115 VAC, 60 Hz
Electrical Service	15 amp circuit
Plumbing Supply	1/4" OD copper, braided stainless steel or PEX tubing
Pressure	4.2–140 psi

Electrical supply, plumbing supply and drain should be located in an adjacent cabinet. If not, they must be located within the shaded area shown in the illustrations below.

**ELECTRICAL | PLUMBING**

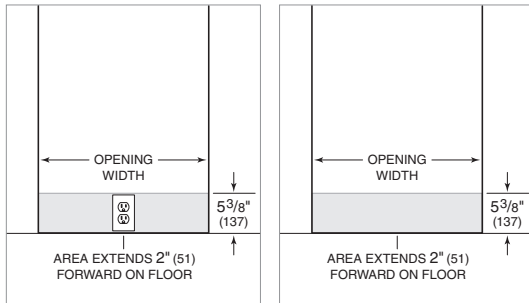

**DIMENSIONS**

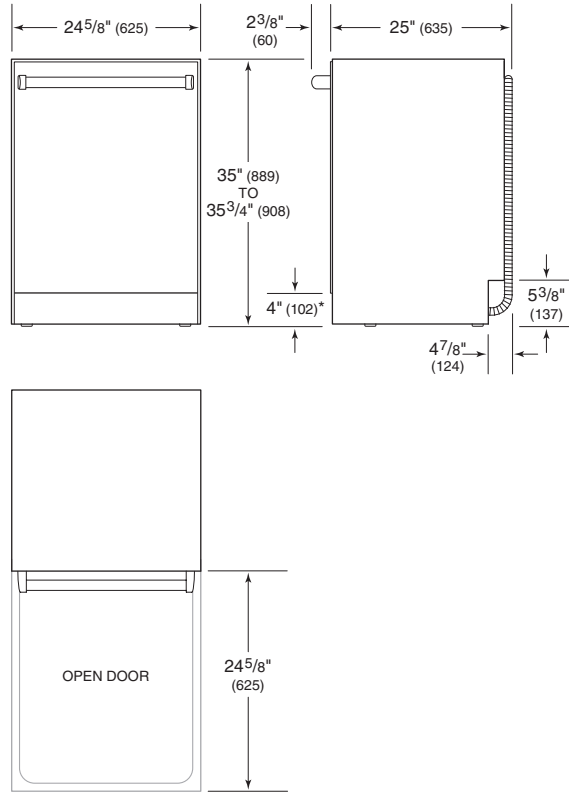

*\*Dimension will vary with product height.*

**INSTALLATION**

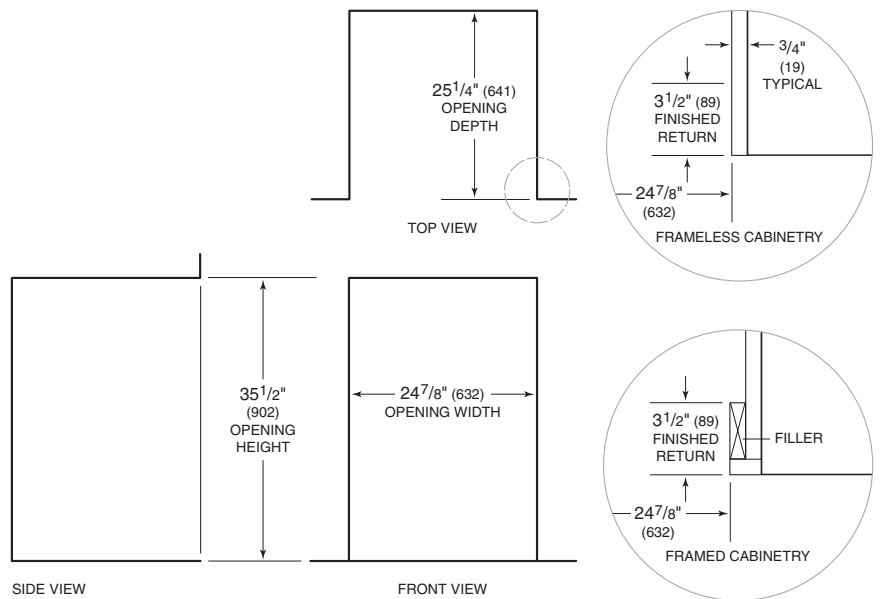

**NOTE:** 3 1/2" (89) finished returns will be visible and should be finished to match cabinetry.